

# Hitch Bike Rack BH2 Manual

Buy online: [www.elecycles.com](http://www.elecycles.com)

Thank you for purchasing our hitch bike rack.

- Please read the instructions carefully prior to installation
- Please keep the instructions properly after the installation is complete

Any problem please contact us on: [www.elecycles.com](http://www.elecycles.com)

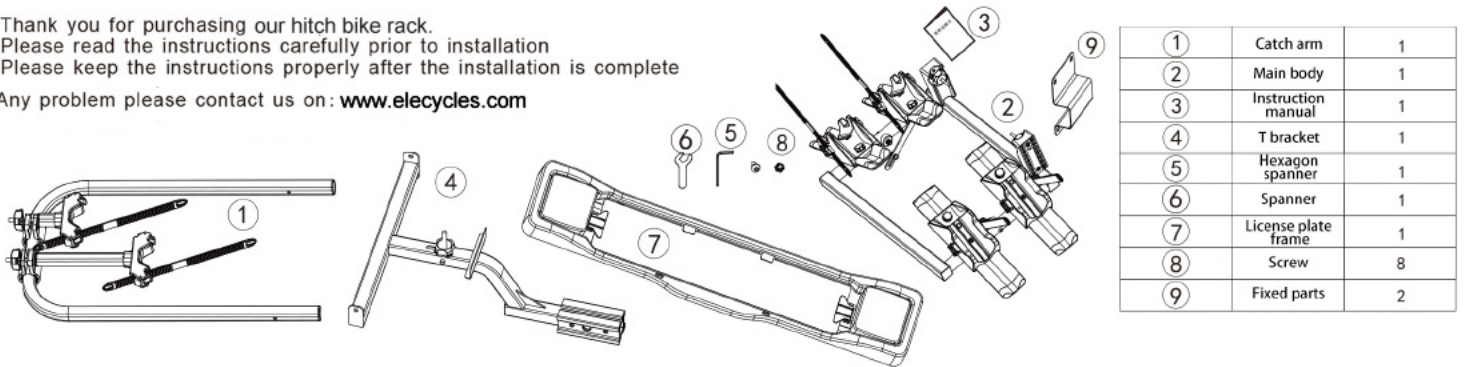

## Safety Instructions

- ▲ It may lead hurt and danger without following instruction manual.
- ▲ Don't wash the bicycle rack--don't use the car wash when bicycle rack is at work.
- ▲ It may lead bicycle rack, bike fall if not follow instruction manual, lead accident and inscrutable danger.
- ▲ The max load- 50kg .
- ▲ Confirm suitable vehicles---- This bike rack is fit for tow hitch, please confirm it before installation.

- ▲ Please follow strictly for install position, load and carrying limit, including instruction manual.
- ▲ Install the bicycle rack in wide and light place.
- ▲ We are not responsible for renovating.
- ▲ Do not speeding, emergency start, unnecessary sharp turns and sudden brake when the product was installed on the vehicle, if these situations occur, the bike rack should be rechecked .
- ▲ Recheck the equipment--recheck the bicycle rack and carrying in the extreme weather, extreme traffic or high speed driving.

## Install Note

- ▲ Please confirm that the vehicles have been installed tow hitch before the bike rack installation.

1 Reversal the main body rack, loosen the two sides screw.

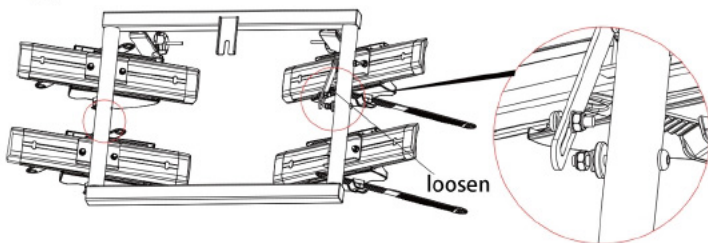

2 Target the groove with T bracket, tighten the knob (when driving, loosening this knob can rotate bike rack and open the trunk)

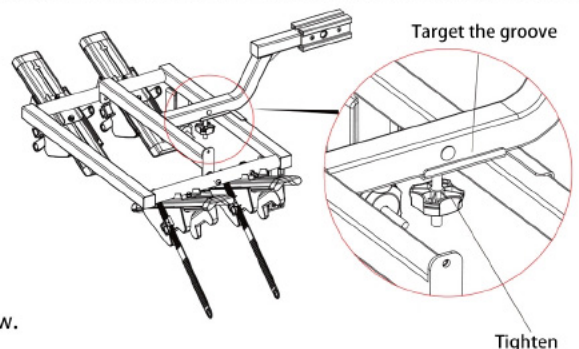

3 Install the T bracket two sides screw, please pay attention to installing the pad as below.

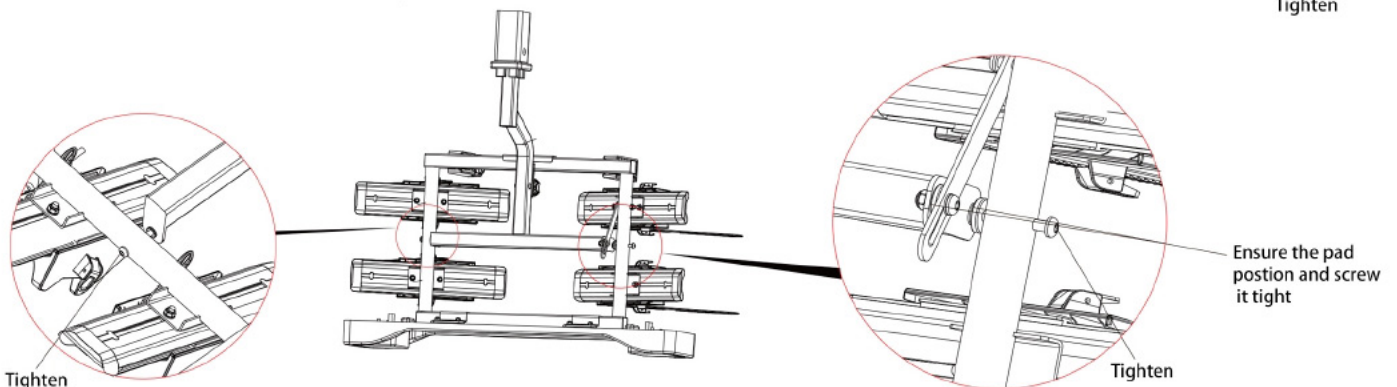

4 Install the License Plate Frame.

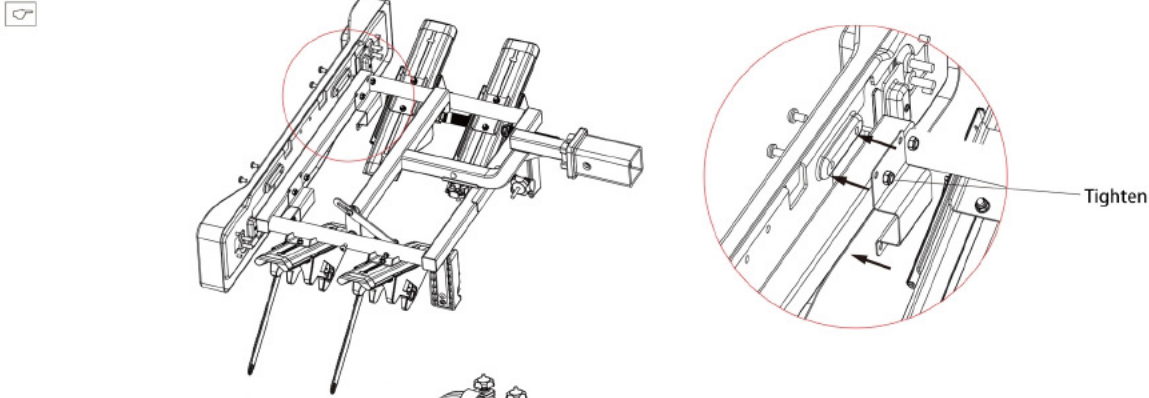

5 Install the catch arm.  
Loosen the button on the main body, target the hole of the arm install the arm then tighten.

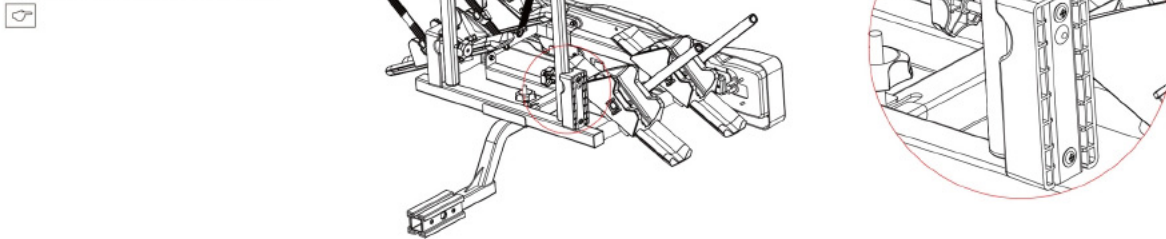

## Install bicycle rack

1 Install the bicycle rack to receiver

Target the T bracket to the receiver, slide the hitch hole to same position to the receiver hole, then fix the bolt

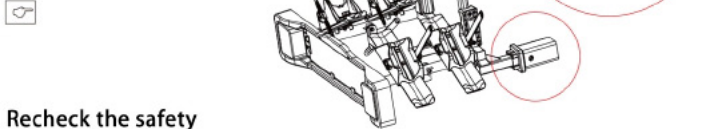

Recheck the safety

Please recheck and ensure bicycle rack is tight enough to place bike  
Please recheck and ensure bicycle rack is installed tight on car

2 Place the bike

Place the bike tyre on the bicycle rack base, fixed bike by the arm and bandage



## Uninstall

Uninstall bike

Loosen the bicycle rack base and catch arm, take out bike

Uninstall the bicycle rack

- 1 Take out the bolt
- 2 Take out the bicycle rack slowly

## Maintenance



1. Wash away mud with water
2. Clean dirt with a wrung -out wet towel
3. Intensive drying in a cool place



- Do not use thinner
- Do not oil the screw or nut

## Fix

1. For fix and replace broken parts, please contact with us
2. We are not responsible for incorrect install and nature disaster  
Email: support@elecycles.com  
Web: www.elecycles.com